

# ROOF REPLACEMENT PROJECT

## DINWIDDIE EDUCATION ANNEX FACILITY

### RRMM ARCHITECTS, PC

ARCHITECTURE / PLANNING / INTERIORS

2900 South Quincy Street, Suite 710  
Arlington, VA 22206  
(703) 998-0101

1317 Executive Boulevard, Suite  
200 Chesapeake, VA 23320  
(757) 622-2828

115 South 15th Street, Suite 502  
Richmond, VA 23219  
(804) 277-8987

310 1st Street SW, Suite 100M  
Roanoke, VA 24011  
(540) 344-1212

3700 Koppers Street, Suite 300  
Baltimore, MD 21227  
(410) 234-8444

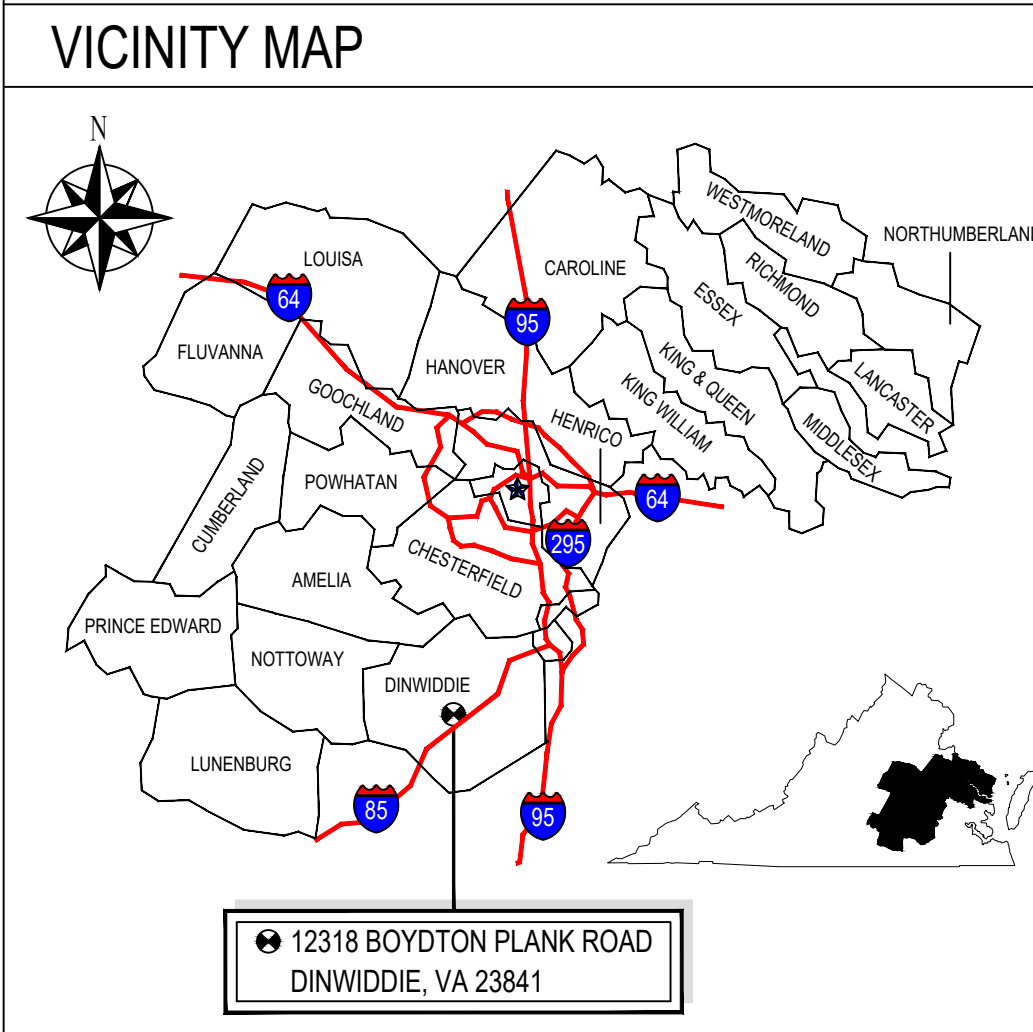

**CONSULTANTS**

**ROOF CONSULTING SERVICES, INC.**  
1660 Mountain Road  
Glen Allen, VA 23060  
Phone: (800) 637-7109  
Fax: (804) 515-0890

**Thompson Consulting Engineers**  
MEP ENGINEERING  
22 Enterprise Parkway, Suite 120  
Hampton, Virginia 23666  
Phone: (757) 599-4415

**SHEET INDEX**

PROJECT TITLE	SHEET
TS	TITLE SHEET
<b>ARCHITECTURAL</b>	
A1.0	ROOF PLAN
A1.1	PROPOSED ROOF TAPER PLAN
A2.0	ROOF DETAILS
A2.1	ROOF DETAILS
<b>MECHANICAL</b>	
M0.1	GENERAL NOTES, LEGEND, ABBREVIATIONS AND SCHEDULE
M1.1	ROOF PLAN - MECHANICAL - DEMOLITION AND NEW WORK
M2.1	MECHANICAL DETAILS AND PHOTOS
<b>ELECTRICAL</b>	
E0.1	GENERAL NOTES, LEGEND, ABBREVIATIONS AND SCHEDULE
E1.1	ROOF PLAN - ELECTRICAL - DEMOLITION AND NEW WORK
E2.1	ELECTRICAL DETAILS AND PHOTOS

**HAZARDOUS MATERIAL**

A. DUE TO THE EXISTING ROOF SYSTEM TYPE, NO SAMPLING FOR ASBESTOS WAS PERFORMED.

B. IF SUSPECTED ASBESTOS MATERIALS ARE FOUND, IMMEDIATELY NOTIFY THE OWNER AND ARCHITECT FOR AWAIT FURTHER DIRECTIONS ON HOW TO PROCEED

**OWNER**

DINWIDDIE COUNTY  
DINWIDDIE EDUCATION ANNEX FACILITY  
12318 BOYDTON PLANK ROAD  
DINWIDDIE, VA 23841  
PHONE: (804) 469-5313

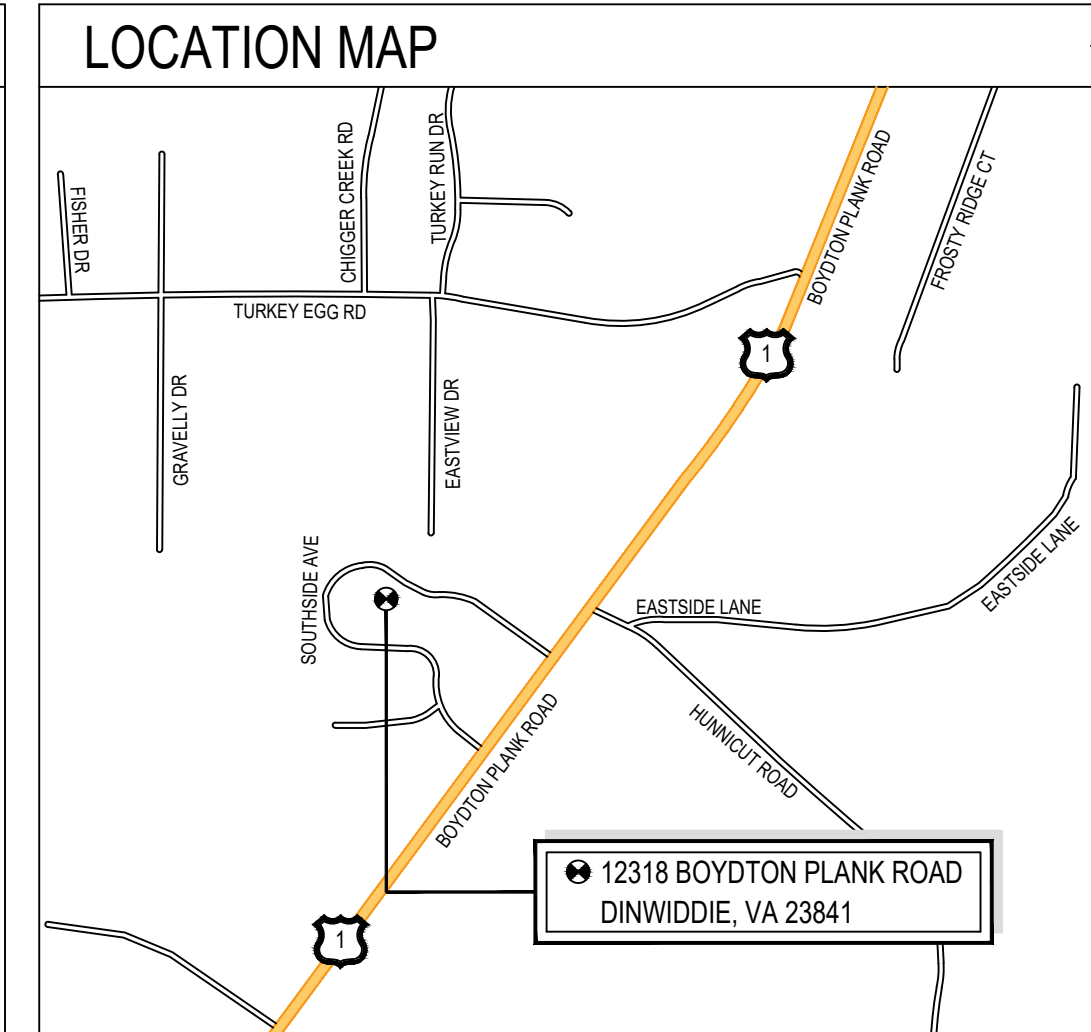

DINWIDDIE EDUCATION ANNEX FACILITY  
12318 BOYDTON PLANK ROAD  
DINWIDDIE, VIRGINIA 23841

DATE	PROJECT	DESIGNED	DRAWN	CHECKED
03/01/2026	251941	BM	JLE	BM
<p>MARK - DATE REVISIONS RECORD DRAWINGS BY DESCRIPTION</p>				

**RRMM ARCHITECTS, PC**  
1317 Executive Blvd, Suite 200  
Chesapeake, Virginia 23320  
(757) 622-2828

PROJECT: ROOF REPLACEMENT PROJECT  
DINWIDDIE COUNTY - DINWIDDIE EDUCATION ANNEX FACILITY  
12318 BOYDTON PLANK ROAD  
DINWIDDIE, VIRGINIA 23841

DRAWING: TITLE SHEET

SHEET: TS

FILE NAME: C:\Users\jbona\AppData\Local\Temp\AutoCad\_5187800 - This Sheet.dwg LAYOUT NAME: TS PLOTTED: Tuesday, May 05, 2026 - 3:14pm

**PLAN NOTES**

- |  |  |
|--|--|
| <p>1 REMOVE EXISTING ROOF DRAIN AND ALL ASSOCIATED COMPONENTS AND PROPERLY DISPOSE OF. DECK OPENING SHALL BE REPLACED WITH NEW TECTUM DECKING PER THE PROJECT SPECIFICATIONS. DRAINAGE OUTLETS WHICH EXIT THE MASONRY WALL SHALL BE REPAIRED TO MATCH EXISTING CONDITIONS AFTER PIPING IS REMOVED.</p> <p>2 ABANDONED PENETRATION AND ALL ASSOCIATED COMPONENTS SHALL BE REMOVED AND PROPERLY DISCARDED AND DECKING REPAIRED PER THE PROJECT SPECIFICATIONS</p> <p>3 INSTALL NEW WOOD FRAMING TO MATCH EXISTING PARAPET FRAMING. FRAMING TO BE FASTENED TO THE EXISTING STRUCTURE AS REQUIRED TO MEET WIND UPLIFT REQUIREMENTS.</p> <p>4 NEW WOOD FRAMED DIVIDER WALL DETAIL PER DETAIL 04/A2.0</p> <p>5 NEW PRIMARY FLOW THROUGH SCUPPER AND CONDUCTOR HEAD AND DOWNSPOUT TO BE INSTALLED PER THE PROJECT DETAILS. ADDITIONAL WOOD BLOCKING SHALL BE INSTALLED AS REQUIRED TO PROPERLY SUPPORT WALL ENDS WHERE BLOCKING IS REMOVED TO PROVIDE THE SCUPPER OPENING</p> | <p>6 NEW DOWNSPOUTS TO BE ROUTED AS REQUIRED TO PROPERLY FUNCTION AND AVOID INTERFERENCE WITH ENTRANCE WAYS AND ELECTRICAL CONDUITS</p> <p>7 SEE SHEETS E1.1 AND E1.2 FOR ELECTRICAL DEMOLITION AND NEW WORK TO BE PERFORMED</p> <p>8 RAISE / RELOCATE EXISTING ELECTRICAL CONDUIT AS REQUIRED TO FACILITATE INSTALLATION OF THE NEW ROOF SYSTEM. ALL MECHANICAL, ELECTRICAL, AND PLUMBING WORK SHALL BE PERFORMED BY A CONTRACTOR LICENSED IN THE RESPECTIVE FIELD.</p> |
|--|--|

**SYMBOL LEGEND**

	CAPPED CURB
	EXHAUST UNIT
	SQUARE CURB TO ROUND VENT
	SQUARE VENT
	VENT
	SCUPPER W/ CONDUCTOR HEAD & DS
	CAPPED PIPE
	PLUMBING VENT
	ROOF DRAIN
	PLAN NOTE
	DETAIL NUMBER
	DETAIL LOCATION

NOTE: PENETRATIONS ARE APPROXIMATE IN SIZE AND LOCATION TO BE USED AS REFERENCE POINTS ONLY

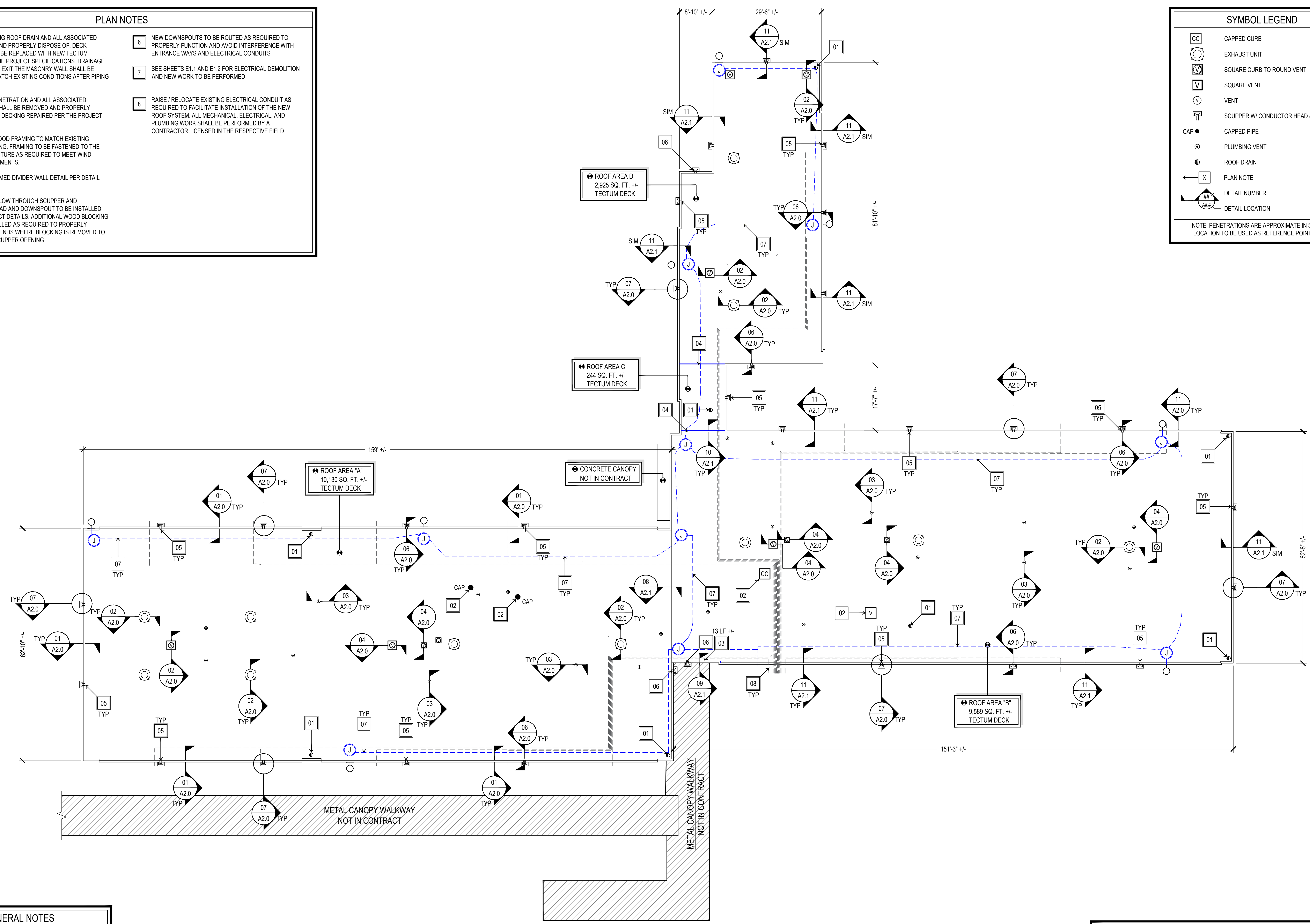

**GENERAL NOTES**

- CONTRACTOR TO PROVIDE AND INSTALL NEW TAPERED POLYSOCYANURATE CRICKETS AS REQUIRED TO PROVIDE A MINIMUM 1/8" PER FOOT SLOPE IN THE VALLEY AT CURBS GREATER THAN 24" AND WHERE SHOWN ON TAPERED DRAWINGS.
- AS PART OF THE BASE BID, CONTRACTOR TO RAISE, MODIFY, AND RELOCATE ALL EXISTING ELECTRICAL, GAS, LIGHTING, CONDUIT, ETC. AS REQUIRED TO FACILITATE INSTALLATION OF NEW ROOF SYSTEM. ALL MECHANICAL, ELECTRICAL, AND PLUMBING WORK SHALL BE PERFORMED BY A CONTRACTOR LICENSED IN THE RESPECTIVE FIELD.
- ALL EXISTING WOOD BLOCKING TO REMAIN IS TO BE INSPECTED AND RE-SECURED AS REQUIRED TO MEET ANSI-SPRI WIND DESIGN STANDARDS REQUIREMENTS

01 ROOF PLAN - 22,888 SQ. FT. +/-  
A1.0 SCALE: 3/32" = 1'-0"

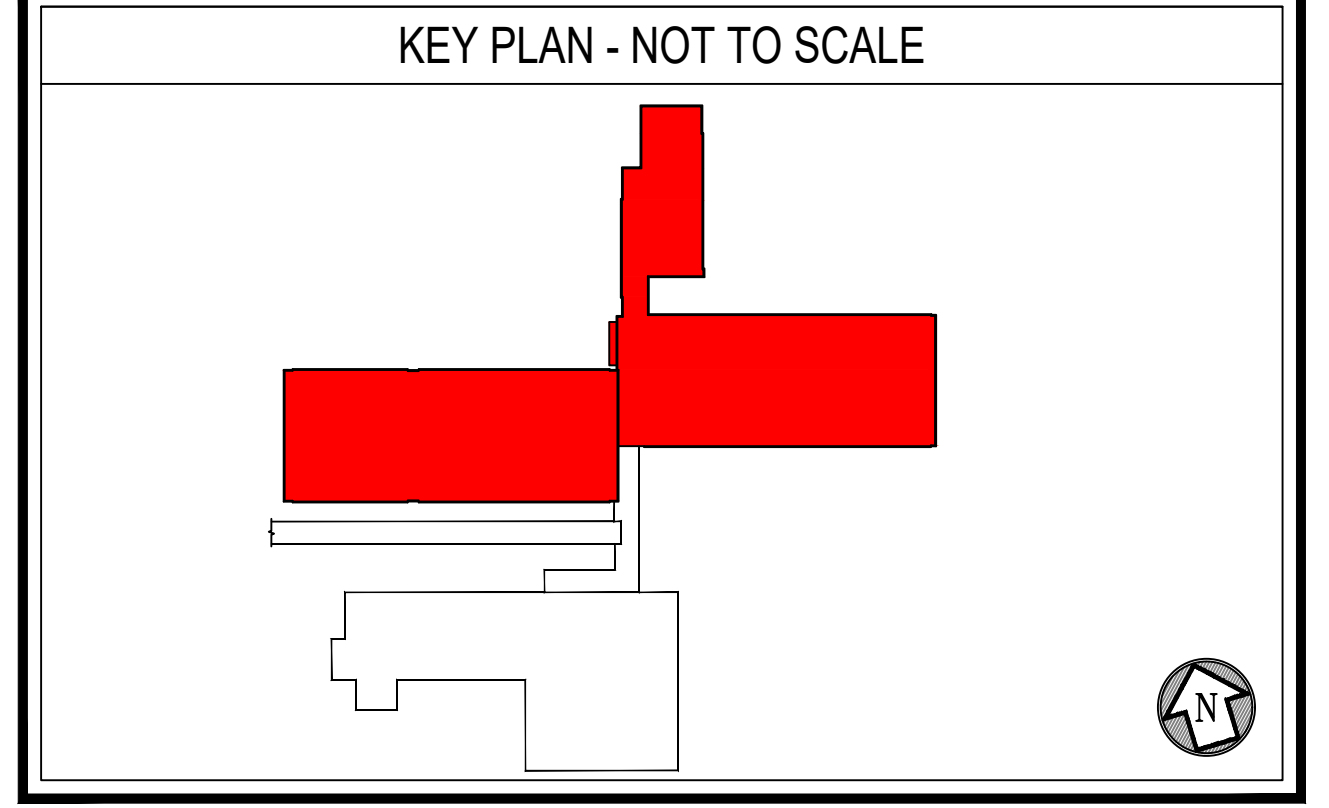

FILE NAME: Z:\DWG\RRMM\Biddie Education Annex Facility\01 - Roof Plans.dwg, LAYOUT NAME: A1.0, PLOTTED: Tuesday, May 05, 2025, 3:14pm

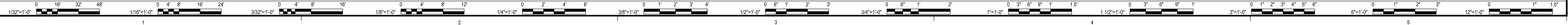

PROJECT	ROOF REPLACEMENT PROJECT DINWIDDIE COUNTY - DINWIDDIE EDUCATION ANNEX FACILITY
DATE	03/01/2025
DESIGNED	25/14/21
DRAWN	BMU
CHECKED	JLE
REVISIONS	BY DATE DESCRIPTION
<p>RRMM ARCHITECTS, P.C. 1317 Executive Blvd, Suite 200 Chesapeake, Virginia 23320 (757)622-2628</p>	
<p>1238 BOYDTON PLANK ROAD DINWIDDIE, VIRGINIA 23041</p>	
SHEET	A1.0

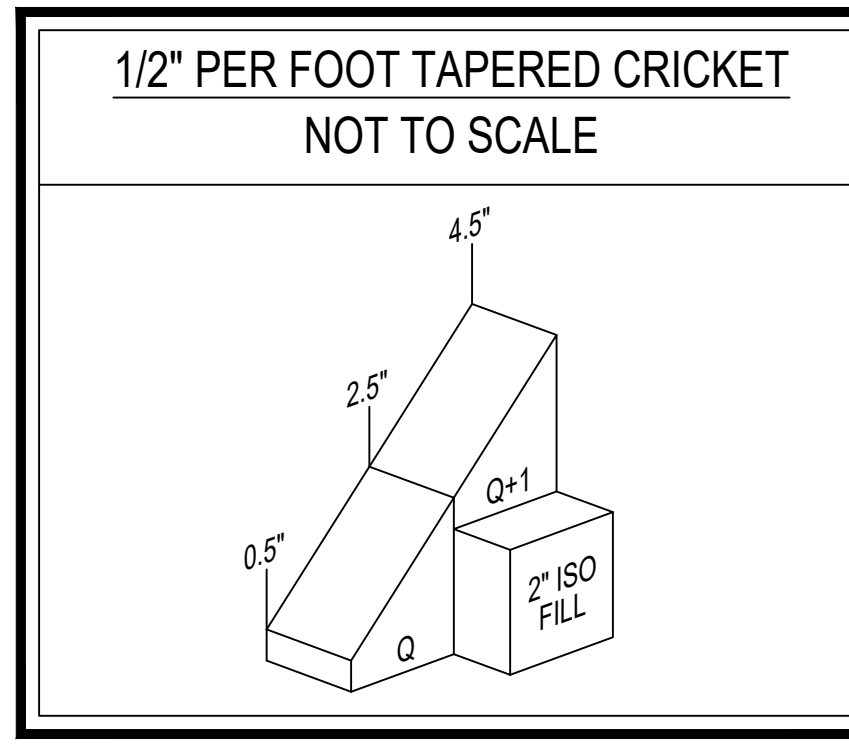
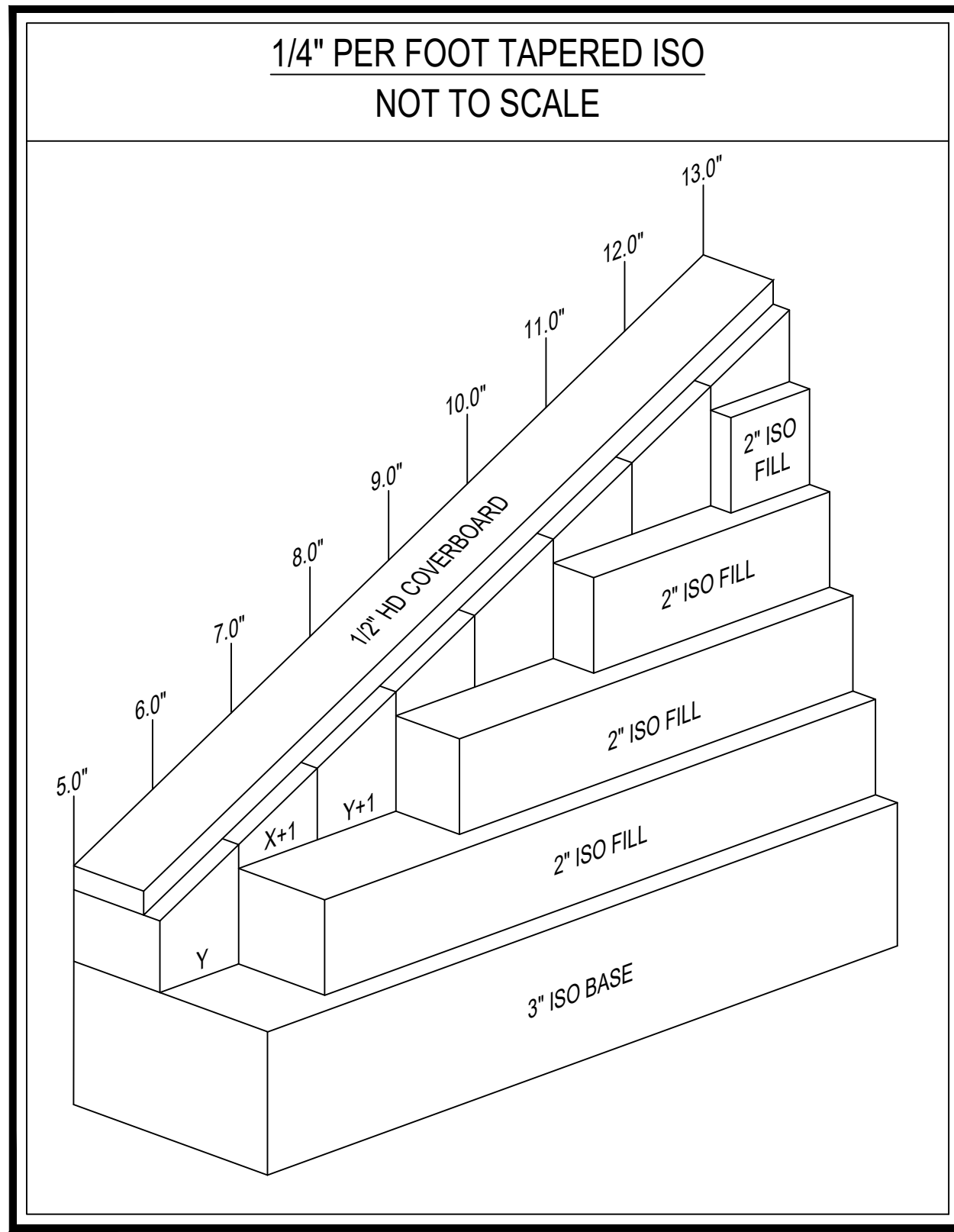

PANEL SCHEDULE				
PANEL	TYPE	THICKNESS	SIZE	SLOPE
Q	CRICKET	0.50"-2.0"	4' X 4'	1/2" / FT
X	TAPERED	0.50"-1.50"	4' X 4'	1/4" / FT.
Y	TAPERED	1.50"-2.50"	4' X 4'	1/4" / FT.
0.5"	HD COVERBOARD	0.5"	4' X 4'	FLAT
2.0"	POLYISO FILL	2.0"	4' X 8'	FLAT
3.0"	POLYISO BASE	3.0"	4' X 8'	FLAT

- TAPER NOTES:**
- ALL TAPERED & FLAT INSULATION FILL SHALL BE POLYISOCYANURATE
  - CONTRACTOR TO TRANSITION PERIMETER CONDITIONS AS REQUIRED
  - CONTRACTOR TO PROVIDE TAPERED EDGE ROOF SUMPS AT ALL DRAINS AS REQUIRED

**SYMBOL LEGEND**

- CAPPED CURB
- EXHAUST UNIT
- SQUARE CURB TO ROUND VENT
- SQUARE VENT
- VENT
- SCUPPER W/ CONDUCTOR HEAD & DS
- CAPPED PIPE
- PLUMBING VENT
- ROOF DRAIN
- PLAN NOTE
- DETAIL NUMBER
- DETAIL LOCATION

NOTE: PENETRATIONS ARE APPROXIMATE IN SIZE AND LOCATION TO BE USED AS REFERENCE POINTS ONLY

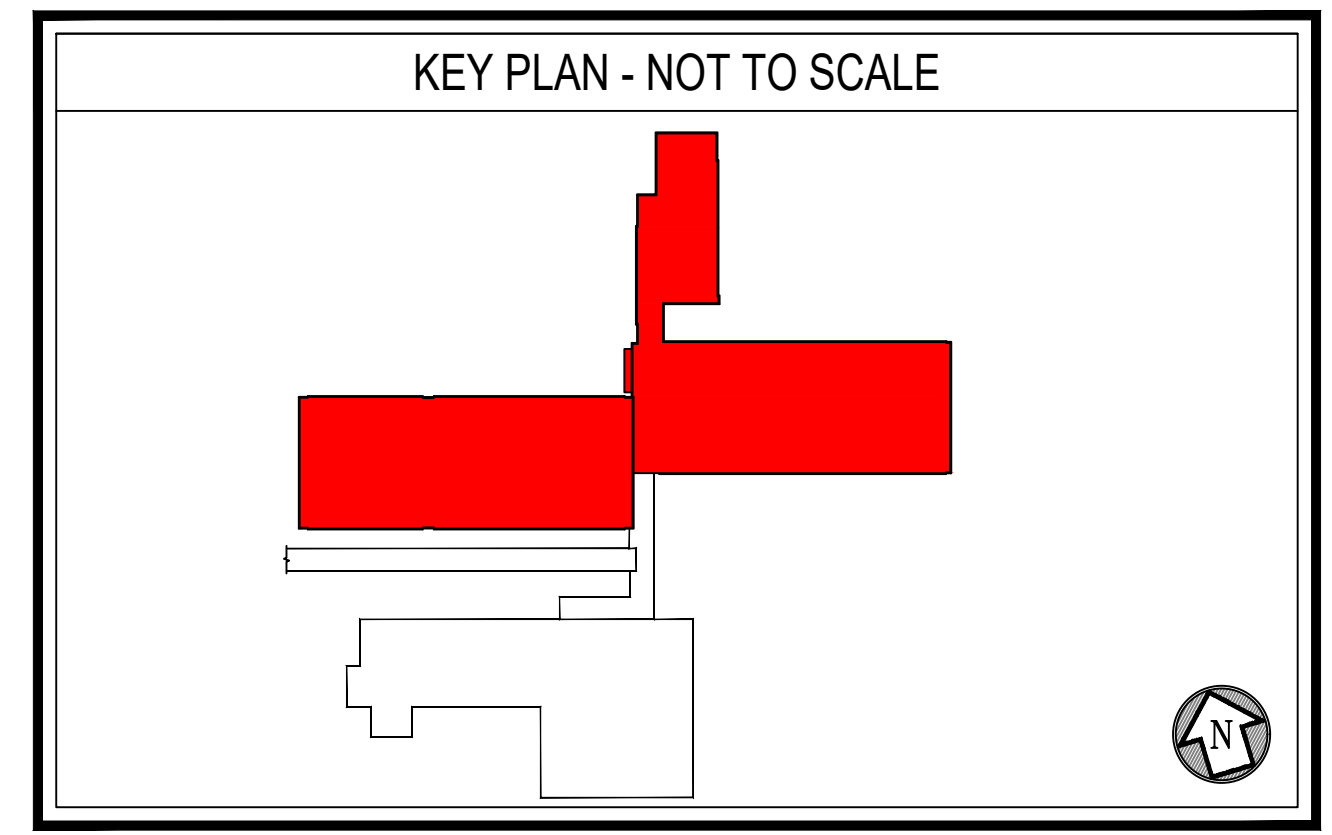
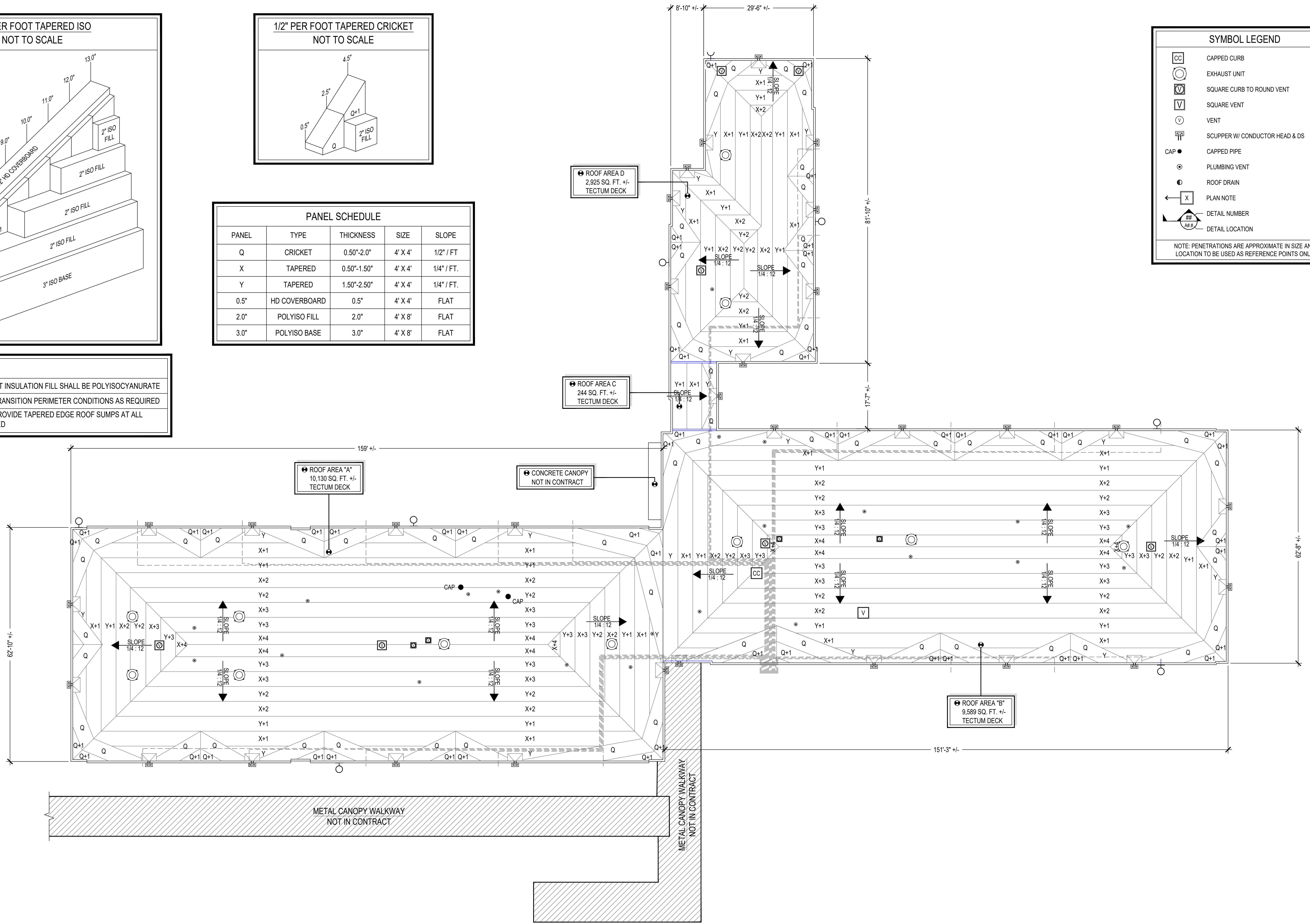

01 PROPOSED ROOF TAPER PLAN  
A.1.1 SCALE: 3/32" = 1'-0"

FILE NAME: Z:\DWG\RRMM\Biddie Education Annex Facility\01 - Roof Plans.dwg LAYOUT NAME: A.1.1 PLOTTED: Tuesday, May 05, 2025 - 3:46pm

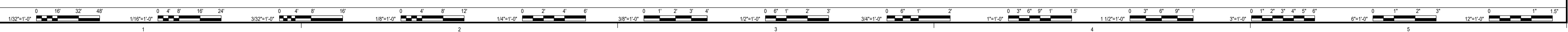

MARK	DATE	BY	DESCRIPTION

DATE	PROJECT	DESIGNED	DRAWN	CHECKED
03/01/2025	251441	BMU	JLE	BMU

**RRMM ARCHITECTS, PC**  
1317 Executive Blvd, Suite 200  
Chesapeake, Virginia 23320  
(757)622-2628

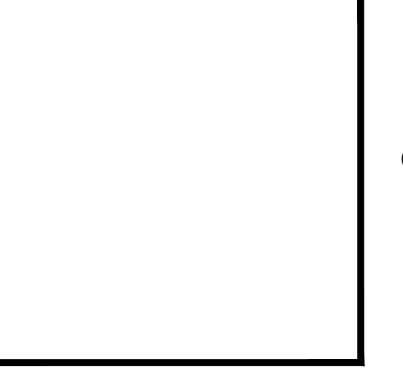

PROJECT: ROOF REPLACEMENT PROJECT  
DINWIDDIE COUNTY - DINWIDDIE EDUCATION ANNEX FACILITY  
1238 BOYDTON PLANK ROAD  
DINWIDDIE, VIRGINIA 23041

DRAWING: PROPOSED ROOF TAPER PLAN

SHEET: A.1.1



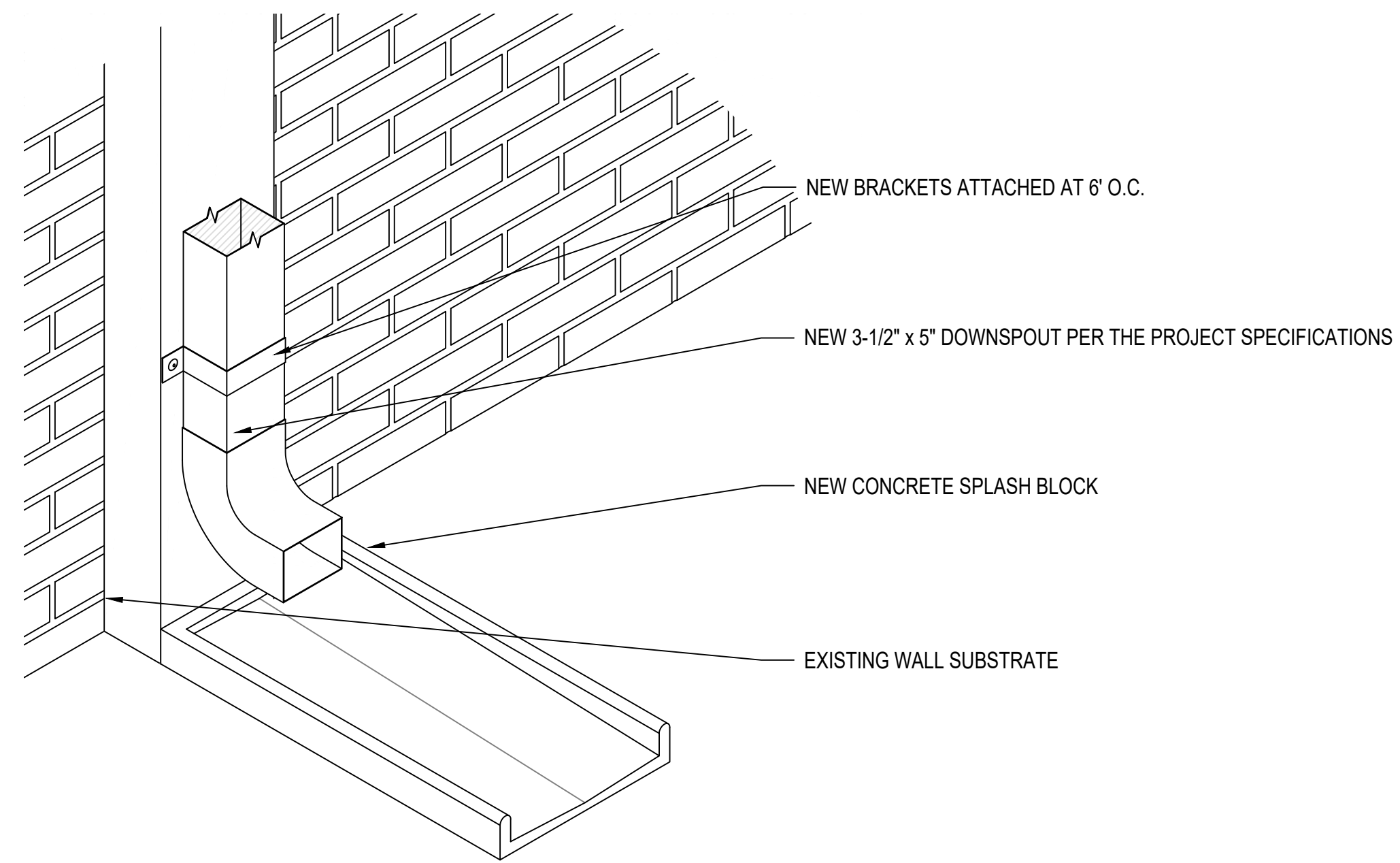

07 DOWNSPOUT  
A2.1 SCALE: N.T.S.

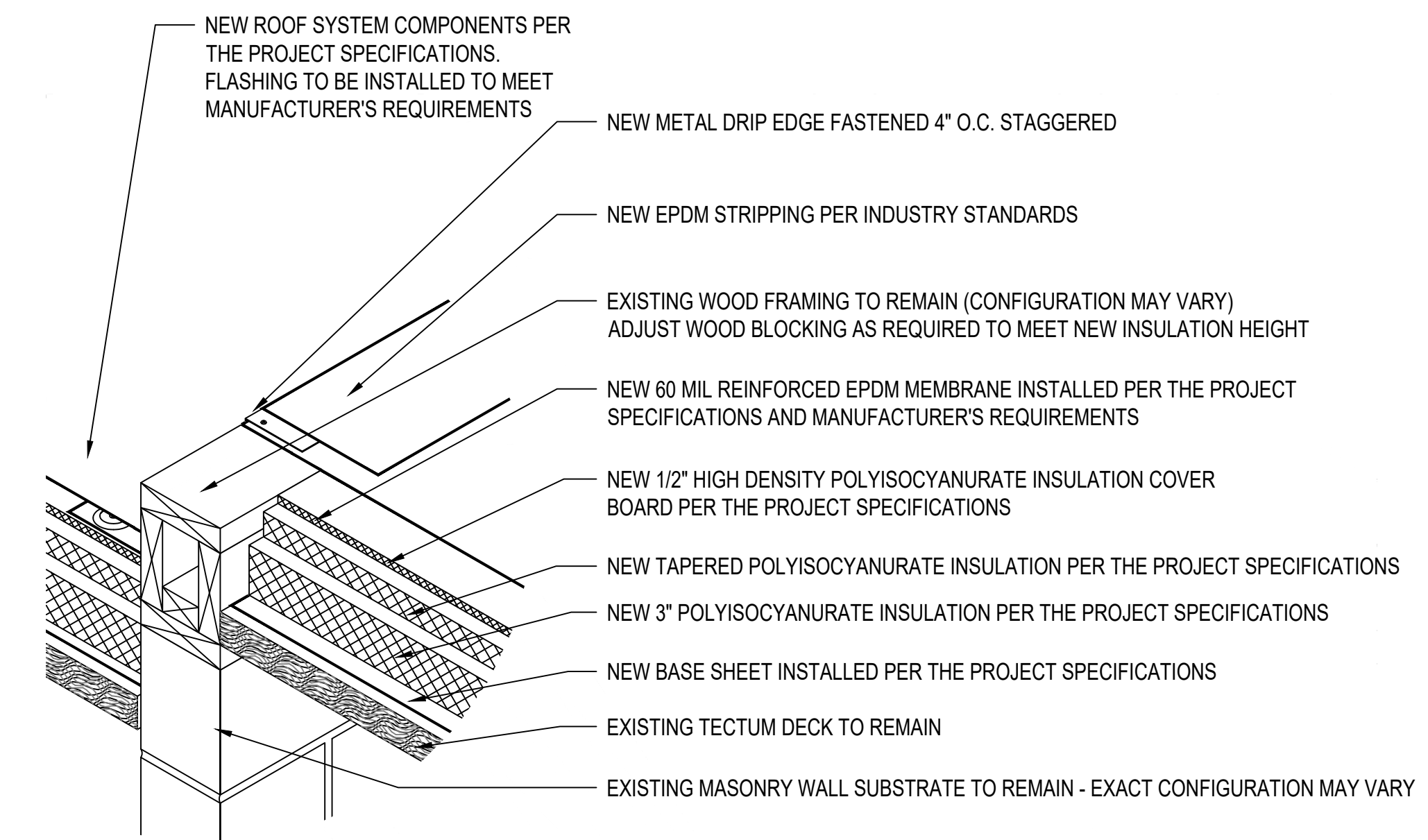

08 AREA A-B TRANSITION  
A2.1 SCALE: N.T.S.

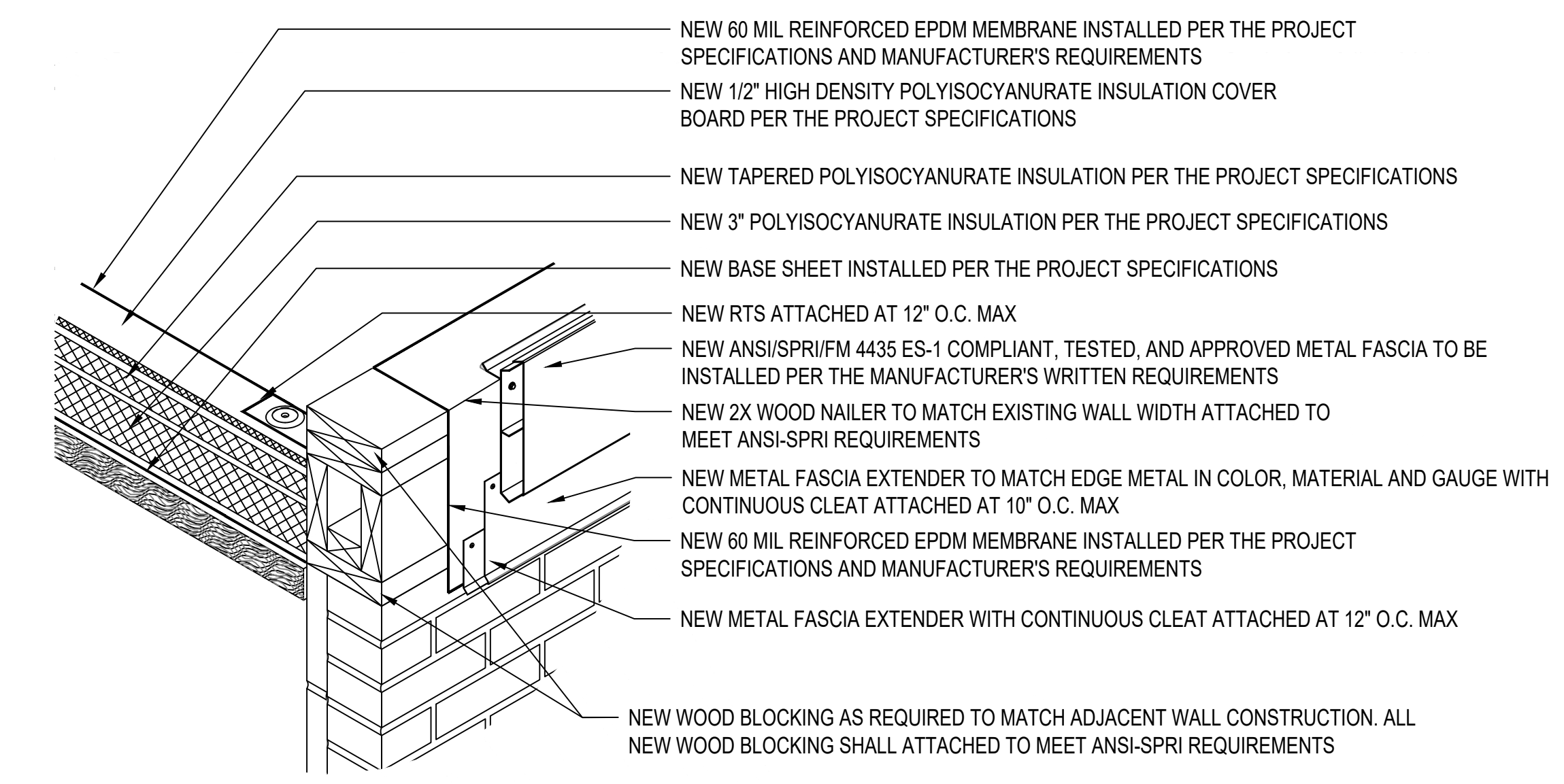

09 METAL EDGE  
A2.1 SCALE: N.T.S.

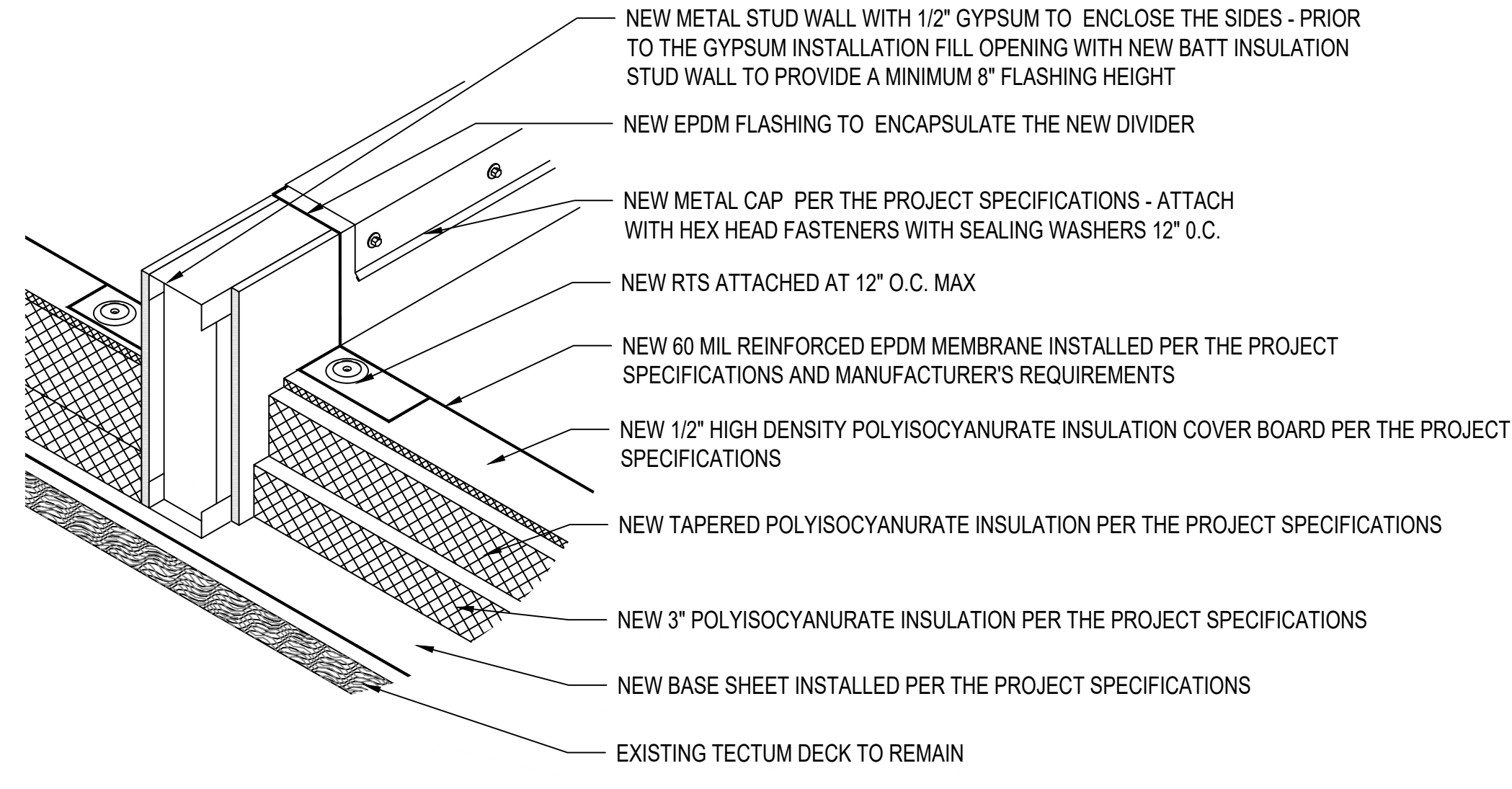

10 NEW AREA DIVIDER  
A2.1 SCALE: N.T.S.

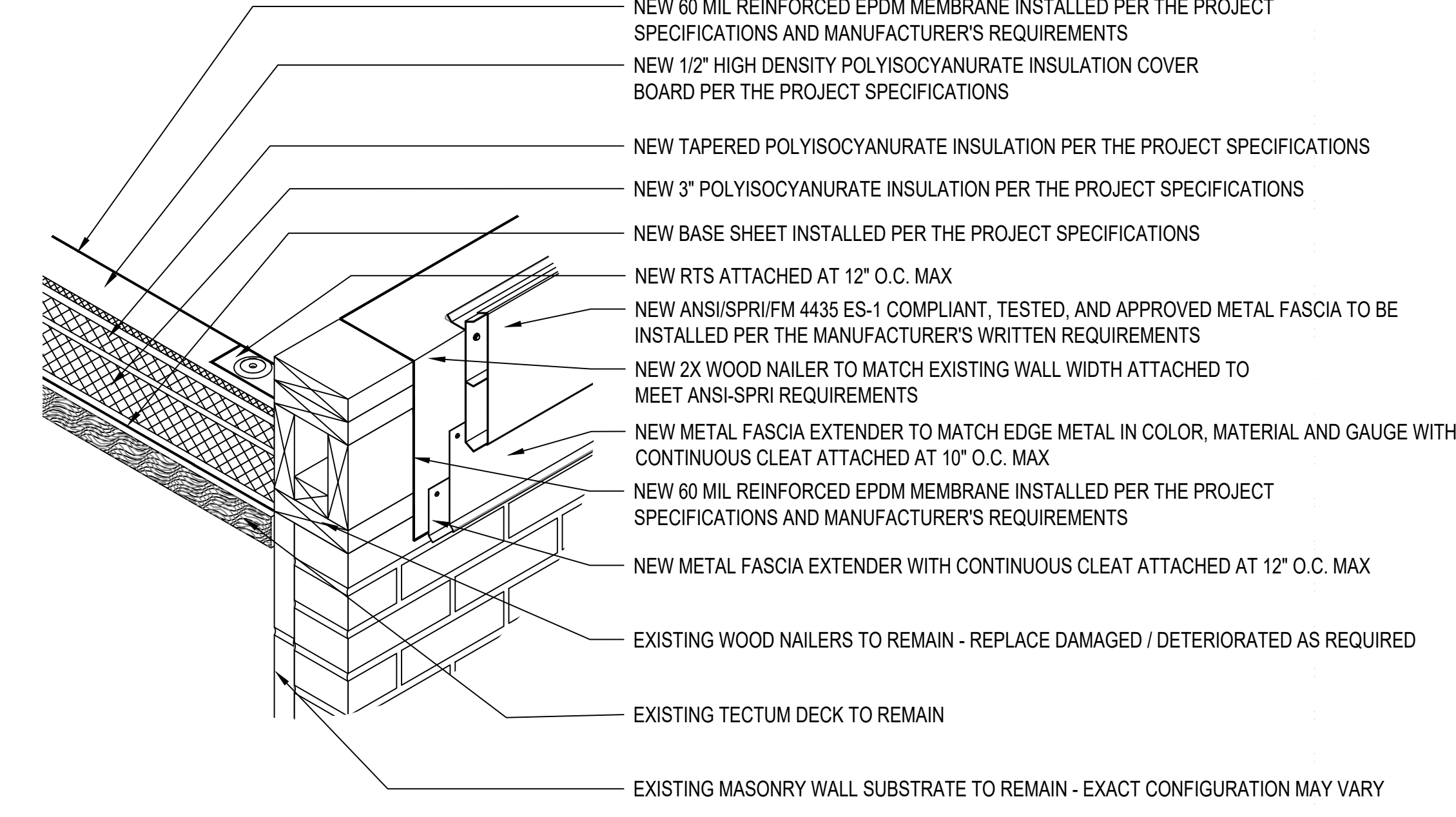

11 METAL EDGE  
A2.1 SCALE: N.T.S.

FILE NAME: C:\Users\jbona\AppData\Local\Temp\AutoCAD\_3187802 - Roof Details.dwg LAYOUT NAME: A2.1 PLOTTED Tuesday, May 05, 2009 - 3:14pm

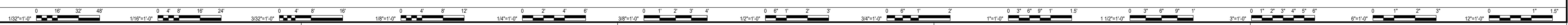

MARK	DATE	BY	DESCRIPTION
REVISIONS			
RECORD DRAWINGS			

DATE	PROJECT	DESIGNED	DRAWN	CHECKED
03/01/2009				

DATE	PROJECT	DESIGNED	DRAWN	CHECKED
03/01/2009				

**RRMM**  
ARCHITECTS, P.C.  
1317 Executive Blvd, Suite 200  
Chesapeake, Virginia 23320  
(757)622-2828

DATE	PROJECT	DESIGNED	DRAWN	CHECKED

PROJECT  
**ROOF REPLACEMENT PROJECT  
DINWIDDIE COUNTY - DINWIDDIE EDUCATION ANNEX FACILITY**  
1238 BOYDTON PLANK ROAD  
DINWIDDIE, VIRGINIA 23041

DRAWING  
**ROOF DETAILS**

SHEET  
**A2.1**

**GENERAL DEMOLITION NOTES**

- WHERE EQUIPMENT IS INDICATED TO BE REMOVED, IT SHALL MEAN COMPLETE REMOVAL OF EQUIPMENT, INCLUDING CURBS, SUPPORTS, GUYS, ANCHORS, BRACKETS, CONTROLS AND INCIDENTAL ITEMS CONNECTED OR FASTENED TO EQUIPMENT. OWNER MAINTAINS THE OWNERSHIP OF ALL ITEMS TAGGED OR IDENTIFIED.

**GENERAL NOTES**

- THE MECHANICAL SYSTEM HAS BEEN DESIGNED IN ACCORDANCE WITH THE 2021 VIRGINIA UNIFORM STATEWIDE BUILDING CODE.
- COORDINATE LOCATION OF ALL ROOF VENTS AND EXHAUST FANS WITH ELECTRICAL CONDUIT, ROOF DRAINS AND ACCESSORIES INSTALLED BY OTHER TRADES SO AS TO PRESENT A NEAT AND ATTRACTIVE INSTALLATION.
- CONTRACTOR SHALL ONLY USE DESIGNATED AREAS WITHIN THE EQUIPMENT FOR PENETRATIONS OF ELECTRICAL CONDUITS AND CONTROL CONDUITS. THESE PENETRATIONS MUST BE WEATHERTIGHT. IF A CONTRACTOR PENETRATES ANY AREAS IN THE EQUIPMENT THAT IS NOT DESIGNATED BY THE MANUFACTURER FOR PENETRATIONS, THE CONTRACTOR SHALL BE RESPONSIBLE FOR ALL REPAIRS TO THE EQUIPMENT, TO INSURE IT IS WEATHERTIGHT. IF EQUIPMENT CAN NOT BE MADE WEATHER TIGHT THE CONTRACTOR SHALL BE REQUIRED TO REPLACE EQUIPMENT AT HIS OWN EXPENSE.
- PROVIDE NEMA 4X-SS ENCLOSURES FOR ALL FIELD INSTALLED CONTROLS, ACCESSORIES, AND ELECTRICAL COMPONENTS INSTALLED EXTERIOR TO THE BUILDING.

**ABBREVIATIONS**

- EF-x EXHAUST FAN DESIGNATION  
 RV-x ROOF VENT DESIGNATION  
 VTR VENT THROUGH ROOF

**LEGEND**

- DIRECTION OF AIRFLOW  
 M 90° RECTANGULAR DUCT ELBOW - TURN UP  
 (EF) ROOF MOUNTED EXHAUST FAN  
 ○ ROOF VENT  
 □ ROOF VENT  
 ● POINT OF RECONNECT  
 ○ POINT OF DISCONNECT  
 (D1) DEMOLITION NOTE  
 1 NEW WORK NOTE  
 P1 PHOTO: NUMBER "P1" TAKEN FROM SHEET MX.X

DEMOLITION NOTES	
NO.	DESCRIPTION
D1	DISCONNECT AND CAREFULLY REMOVE ROOF VENT AND STORE FOR REINSTALLATION. REMOVE ROOF CURB COMPLETE. UNIT SHALL NOT BE PLACED DIRECTLY ON THE ROOF AT ANY POINT DURING CONSTRUCTION. PROVIDE 1/2" PLYWOOD TEMPORARY COVER AND WEATHERPROOF TARP FOR REMAINING OPENING UNTIL ROOF IS REPLACED.
D2	DISCONNECT AND CAREFULLY REMOVE EXHAUST FAN AND STORE FOR REINSTALLATION. REMOVE ROOF CURB COMPLETE. UNIT SHALL NOT BE PLACED DIRECTLY ON THE ROOF AT ANY POINT DURING CONSTRUCTION. PROVIDE 1/2" PLYWOOD TEMPORARY COVER AND WEATHERPROOF TARP FOR REMAINING OPENING UNTIL ROOF IS REPLACED.
D3	REMOVE ROOF VENT AND CURB COMPLETE.

NEW WORK NOTES	
NO.	DESCRIPTION
1	CONTRACTOR TO REINSTALL ROOF VENT TO EXISTING DUCTWORK PENETRATION. PROVIDE NEW ROOF CURB. CONTRACTOR SHALL FIELD MEASURE EXHAUST FAN TO MATCH UP WITH ROOF CURB. UNIT SHALL BE REINSTALLED LEVEL. REFER TO M0.1 FOR DETAILS. REFER TO ARCHITECTURAL DRAWINGS FOR FLASHING INFORMATION.
2	CONTRACTOR TO REINSTALL EXHAUST FAN TO EXISTING DUCTWORK PENETRATION. PROVIDE NEW ROOF CURB. CONTRACTOR SHALL FIELD MEASURE EXHAUST FAN TO MATCH UP WITH ROOF CURB. UNIT SHALL BE REINSTALLED LEVEL. REFER TO M0.1 FOR DETAILS. REFER TO ARCHITECTURAL DRAWINGS FOR FLASHING INFORMATION.

NOTE: EXISTING CONDITIONS ILLUSTRATED HAVE BEEN DETERMINED FROM ORIGINAL CONSTRUCTION DOCUMENTS AND LIMITED NON-INVASIVE FIELD INVESTIGATION. THE CONTRACTOR SHALL INVESTIGATE FIELD CONDITIONS PRIOR TO COMMENCEMENT OF WORK, COORDINATE AND MAKE ADJUSTMENTS AS NECESSARY.

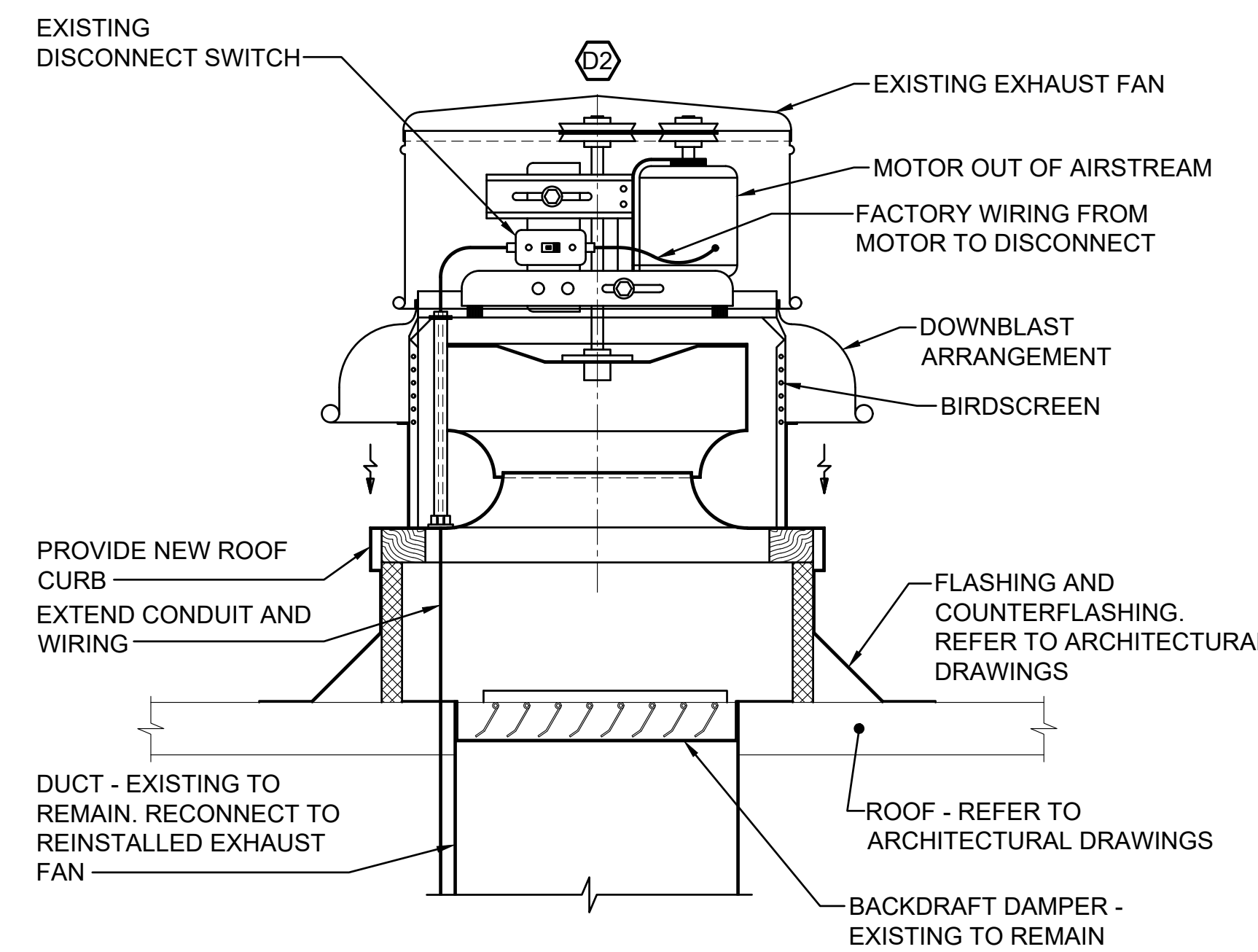

- NOTES:  
 1. BELT-DRIVE SHOWN; DIRECT-DRIVE SIMILAR.  
 2. REFER TO ARCHITECTURAL DRAWINGS FOR ROOF ATTACHMENT DETAILS AND REQUIREMENTS.

**ROOF EXHAUST FAN DETAIL**

NOT TO SCALE

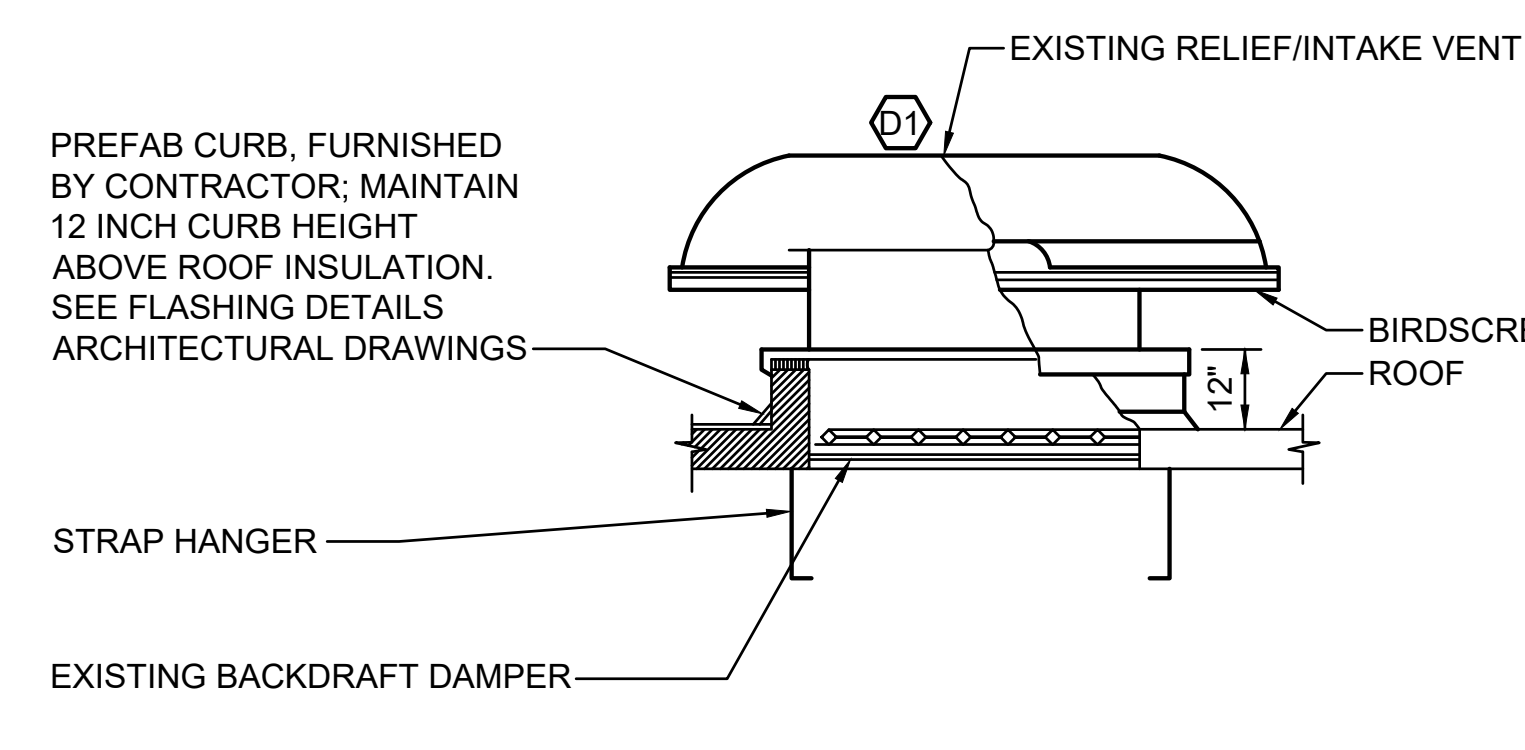

NOTE: PROVIDE FOAM RUBBER GASKETING WITH WATERPROOF CAULKING ALL 4 SIDES BETWEEN FAN FRAME AND WOOD NAILER

**RELIEF/INTAKE VENT DETAIL**

NOT TO SCALE



**P1** ROOF VENT DEMOLITION PHOTO  
 M1.1 NOT TO SCALE



**P2** TYPICAL ROOF VENT REPLACEMENT PHOTO  
 M1.1 NOT TO SCALE



**P3** TYPICAL EXHAUST FAN REPLACEMENT PHOTO  
 M1.1 NOT TO SCALE

DESCRIPTION
REVISIONS
MARK DATE
BY

**THOMPSON**  
 CONSULTING ENGINEERS  
 1001 W. MAIN ST., SUITE 200  
 CHARLOTTE, NC 28202  
 (704) 375-1100

DATE	PROJECT	DESIGNED	DRAWN	CHECKED
05/15/2026	TAM	JAR	GJA	

**RRMM**  
 ARCHITECTS, PC  
 1317 Executive Blvd, Suite 200  
 Chesapeake, Virginia 23320  
 (757) 622-2828

COMMONWEALTH OF VIRGINIA  
 PROFESSIONAL REGISTERED  
 GREGORY J ALLEN III  
 Lic. No. 052245  
 05-15-2026

HISTORIC SOUTHSIDE HIGH SCHOOL EDUCATION CENTER  
 DINWIDDIE COUNTY - DINWIDDIE EDUCATION ANNEX FACILITY  
 1238 BOYDTON PLANK ROAD  
 DINWIDDIE, VIRGINIA 23041  
 GENERAL NOTES, LEGEND, ABBREVIATIONS,  
 SCHEDULE, DETAILS AND PHOTOS

SHEET  
**M0.1**

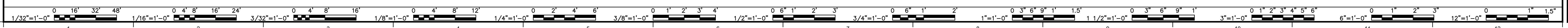

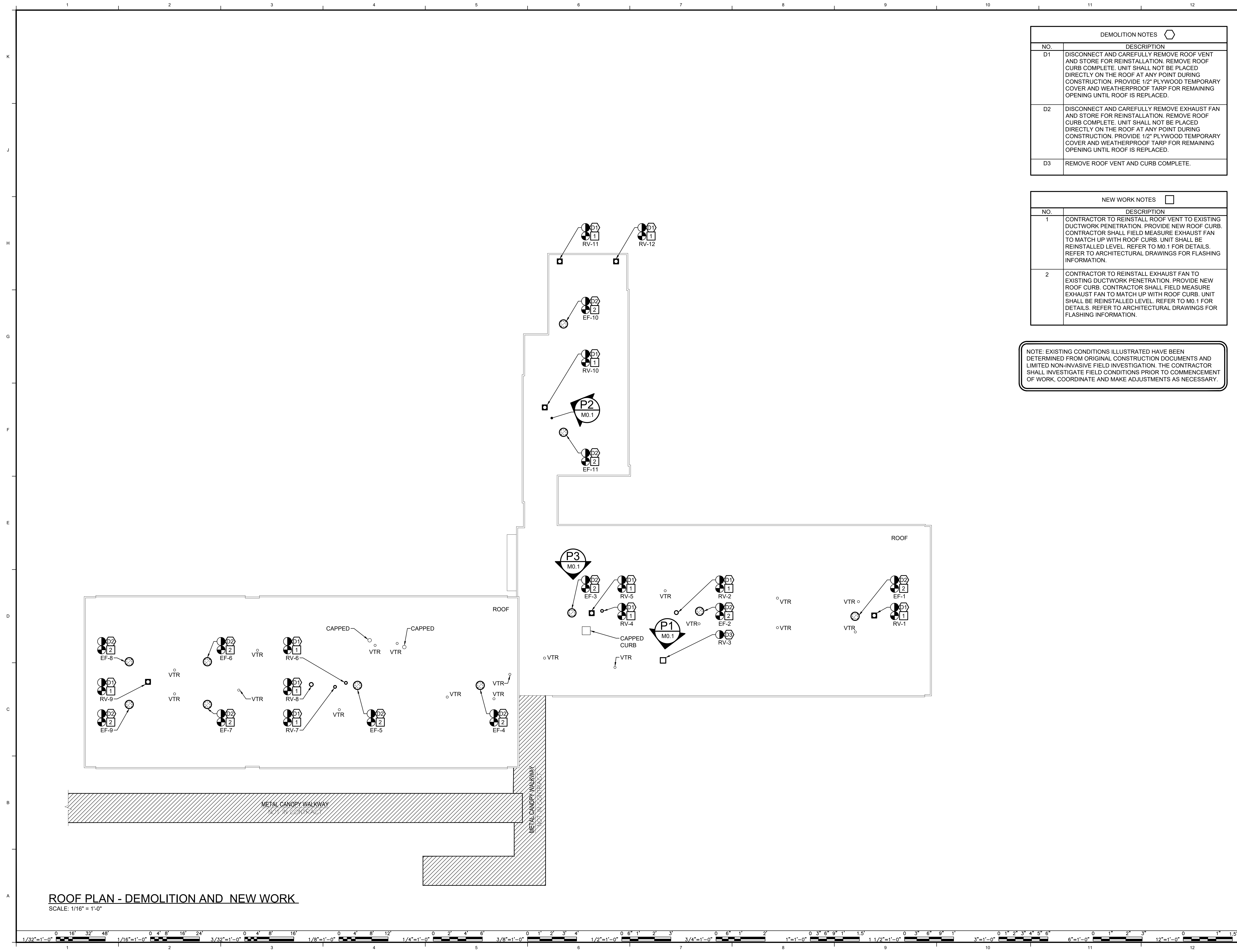

**ROOF PLAN - DEMOLITION AND NEW WORK**  
SCALE: 1/16" = 1'-0"

DEMOLITION NOTES	
NO.	DESCRIPTION
D1	DISCONNECT AND CAREFULLY REMOVE ROOF VENT AND STORE FOR REINSTALLATION. REMOVE ROOF CURB COMPLETE. UNIT SHALL NOT BE PLACED DIRECTLY ON THE ROOF AT ANY POINT DURING CONSTRUCTION. PROVIDE 1/2" PLYWOOD TEMPORARY COVER AND WEATHERPROOF TARP FOR REMAINING OPENING UNTIL ROOF IS REPLACED.
D2	DISCONNECT AND CAREFULLY REMOVE EXHAUST FAN AND STORE FOR REINSTALLATION. REMOVE ROOF CURB COMPLETE. UNIT SHALL NOT BE PLACED DIRECTLY ON THE ROOF AT ANY POINT DURING CONSTRUCTION. PROVIDE 1/2" PLYWOOD TEMPORARY COVER AND WEATHERPROOF TARP FOR REMAINING OPENING UNTIL ROOF IS REPLACED.
D3	REMOVE ROOF VENT AND CURB COMPLETE.

NEW WORK NOTES	
NO.	DESCRIPTION
1	CONTRACTOR TO REINSTALL ROOF VENT TO EXISTING DUCTWORK PENETRATION. PROVIDE NEW ROOF CURB. CONTRACTOR SHALL FIELD MEASURE EXHAUST FAN TO MATCH UP WITH ROOF CURB. UNIT SHALL BE REINSTALLED LEVEL. REFER TO M0.1 FOR DETAILS. REFER TO ARCHITECTURAL DRAWINGS FOR FLASHING INFORMATION.
2	CONTRACTOR TO REINSTALL EXHAUST FAN TO EXISTING DUCTWORK PENETRATION. PROVIDE NEW ROOF CURB. CONTRACTOR SHALL FIELD MEASURE EXHAUST FAN TO MATCH UP WITH ROOF CURB. UNIT SHALL BE REINSTALLED LEVEL. REFER TO M0.1 FOR DETAILS. REFER TO ARCHITECTURAL DRAWINGS FOR FLASHING INFORMATION.

NOTE: EXISTING CONDITIONS ILLUSTRATED HAVE BEEN DETERMINED FROM ORIGINAL CONSTRUCTION DOCUMENTS AND LIMITED NON-INVASIVE FIELD INVESTIGATION. THE CONTRACTOR SHALL INVESTIGATE FIELD CONDITIONS PRIOR TO COMMENCEMENT OF WORK, COORDINATE AND MAKE ADJUSTMENTS AS NECESSARY.

MARK	DATE	BY	DESCRIPTION
			RECORD DRAWINGS

**THOMPSON**  
CONSULTING ENGINEERS  
12345 MAIN STREET  
SUITE 100  
DINWIDDIE, VIRGINIA 23041  
PHONE: 757-262-2828

DATE	PROJECT	DESIGNED	DRAWN	CHECKED
05/15/2026		TAM	JAR	GJA

**RRMM**  
ARCHITECTS, P.C.  
1317 Executive Blvd, Suite 200  
Chesapeake, Virginia 23320  
(757) 622-2828

COMMONWEALTH OF VIRGINIA  
GREGORY J ALLEN III  
Lic. No. 052245  
05-15-2026

**HISTORIC SOUTHSIDE HIGH SCHOOL EDUCATION CENTER  
DINWIDDIE COUNTY - DINWIDDIE EDUCATION ANNEX FACILITY**  
1238 BOYDTON PLANK ROAD  
DINWIDDIE, VIRGINIA 23041

**OVERALL ROOF PLAN - DEMOLITION AND NEW WORK**

SHEET  
**M1.1**

**ELECTRICAL LEGEND:**

**LIGHTING:**

HO EXISTING WALL MOUNTED LIGHT FIXTURE.

**POWER:**

⊙ ELECTRICAL CONNECTION TO EQUIPMENT.

----- CONDUIT RUN EXPOSED ON ROOF.

===== SURFACE MOUNTED CONDUIT.

**GENERAL:**

1 NEW WORK NOTE INDICATOR.

Ⓜ DEMOLITION NOTE INDICATOR.

PHOTO: NUMBER "1" TAKEN FROM SHEET E1.1.

**GENERAL NOTES:**

- COORDINATE WITH MECHANICAL CONTRACTOR AND DRAWINGS FOR EXACT LOCATION OF EQUIPMENT REQUIRING ELECTRICAL CONNECTIONS INCLUDING BUT NOT LIMITED TO NUMBER OF ELECTRICAL CONNECTIONS. MAKE ADJUSTMENTS TO CONDUIT ROUTING, AND PLACEMENT OF DISCONNECTS AND STARTERS AS REQUIRED.
- WHERE THE TERM "BRANCH CIRCUITRY" IS USED ON THESE DRAWINGS, IT IS TO BE CONSTRUED TO MEAN CONDUIT AND CONDUCTORS.
- WHERE CONFLICTS ARE FOUND BETWEEN DRAWINGS, DETAILS, OR SPECIFICATIONS, THE MORE STRINGENT REQUIREMENT SHALL APPLY. NOTIFY ARCHITECT OF DISCREPANCY IN WRITING.

**GENERAL DEMOLITION NOTES:**

- VERIFY ALL CIRCUITS SAVED DURING DEMOLITION FOR REUSE AS TO WIRE SIZE AND POINT OF ORIGIN.
- EXERCISE CARE IN REMOVING MATERIAL AND EQUIPMENT DURING DEMOLITION. REPAIR ALL DAMAGE TO EXISTING SURFACES OR EXISTING EQUIPMENT TO REMAIN TO THE SATISFACTION OF THE ARCHITECT AND OWNER AT NO ADDITION COST TO THE OWNER.
- PATCH ALL OPENINGS IN ROOF CAUSED BY REMOVAL OF EQUIPMENT AND CONDUIT WITH SIMILAR MATERIALS AND FINISH TO MATCH ADJACENT SURFACES.
- PROVIDE ALL ELECTRICAL DEMOLITION WORK NECESSARY TO INSTALL NEW WORK. REROUTE AND RECONNECT TO ALL CIRCUITS THAT ARE REQUIRED TO REMAIN IN USE BUT INTERFERES WITH NEW CONSTRUCTION.
- EXISTING CONDITIONS ILLUSTRATED HAVE BEEN DETERMINED FROM ORIGINAL CONSTRUCTION DOCUMENTS AND LIMITED NON-INVASIVE FIELD INVESTIGATIONS. THE CONTRACTOR SHALL INVESTIGATE FIELD CONDITIONS PRIOR TO COMMENCEMENT OF WORK. COORDINATE AND MAKE ADJUSTMENTS AS NECESSARY.

**ABBREVIATIONS:**

- A AMPERE  
 EF EXHAUST FAN  
 GRS GALVANIZED RIGID STEEL  
 LFNC LIQUIDTIGHT FLEXIBLE NON-METALLIC CONDUIT

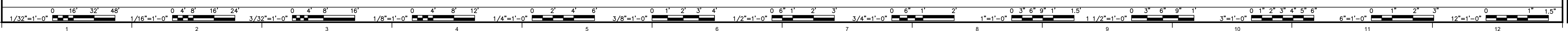

	DESCRIPTION
	BY
	REVISIONS
	MARK DATE

**THOMPSON**  
 CONSULTING ENGINEERS  
 1000 W. MARKET STREET, SUITE 200  
 CHARLOTTE, NC 28202  
 PHONE: 704.375.1200

05/15/2026	2/18/08	LSC	LSC	KC
DATE	PROJECT	DESIGNED	DRAWN	CHECKED

**RRMM**  
 ARCHITECTS, P.C.  
 1317 Executive Blvd, Suite 200  
 Chesapeake, Virginia 23320  
 (757)622-2828



HISTORIC SOUTHSIDE HIGH SCHOOL EDUCATION CENTER  
 DINWIDDIE COUNTY - DINWIDDIE EDUCATION ANNEX FACILITY  
 1238 BOYDTON PLANK ROAD  
 DINWIDDIE, VIRGINIA 23041

**ELECTRICAL LEGEND AND NOTES**

PROJECT SHEET  
 DRAWING

SHEET  
**E0.1**

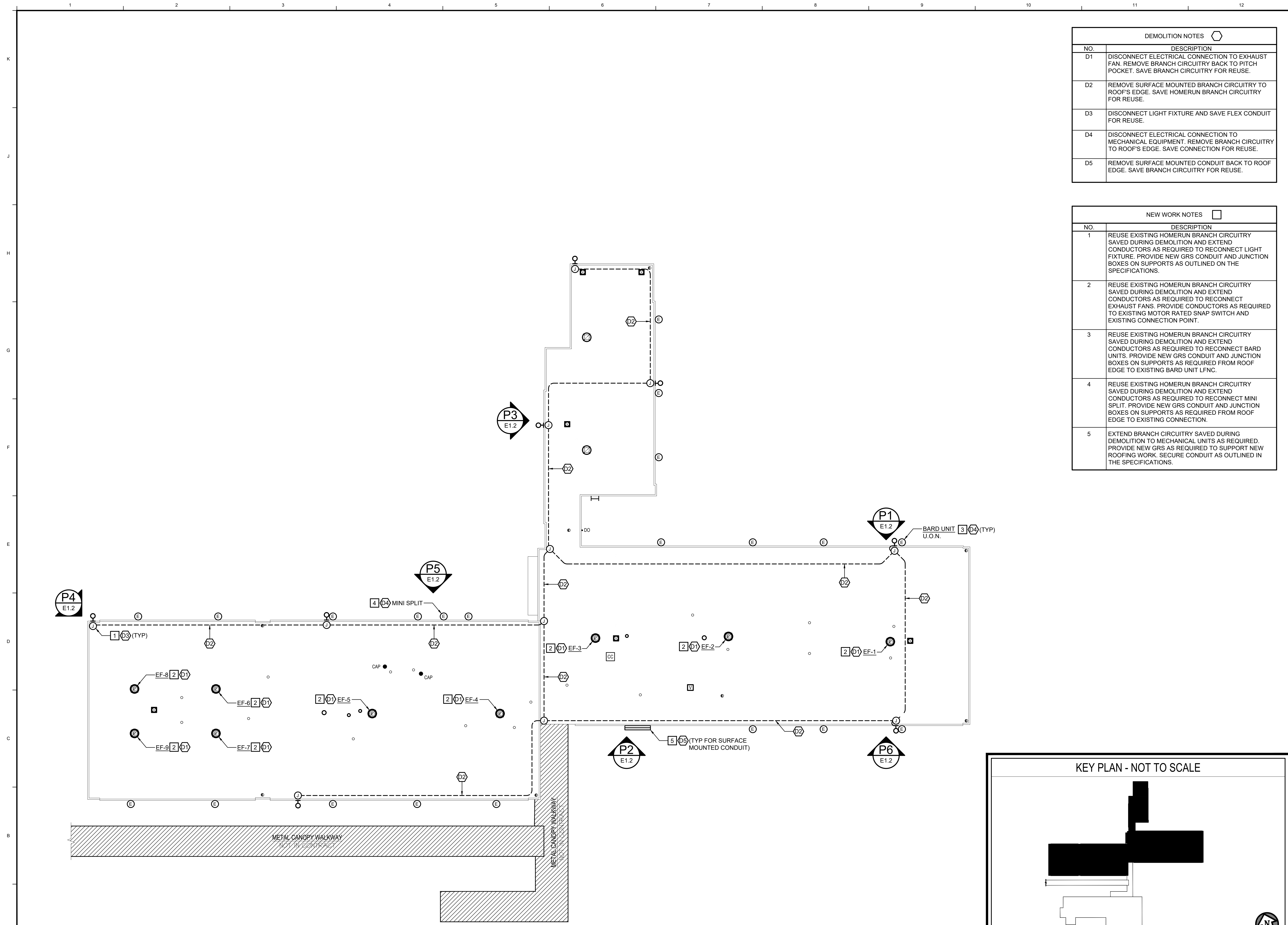

DEMOLITION NOTES	
NO.	DESCRIPTION
D1	DISCONNECT ELECTRICAL CONNECTION TO EXHAUST FAN. REMOVE BRANCH CIRCUITRY BACK TO PITCH POCKET. SAVE BRANCH CIRCUITRY FOR REUSE.
D2	REMOVE SURFACE MOUNTED BRANCH CIRCUITRY TO ROOF'S EDGE. SAVE HOMERUN BRANCH CIRCUITRY FOR REUSE.
D3	DISCONNECT LIGHT FIXTURE AND SAVE FLEX CONDUIT FOR REUSE.
D4	DISCONNECT ELECTRICAL CONNECTION TO MECHANICAL EQUIPMENT. REMOVE BRANCH CIRCUITRY TO ROOF'S EDGE. SAVE CONNECTION FOR REUSE.
D5	REMOVE SURFACE MOUNTED CONDUIT BACK TO ROOF EDGE. SAVE BRANCH CIRCUITRY FOR REUSE.

NEW WORK NOTES	
NO.	DESCRIPTION
1	REUSE EXISTING HOMERUN BRANCH CIRCUITRY SAVED DURING DEMOLITION AND EXTEND CONDUCTORS AS REQUIRED TO RECONNECT LIGHT FIXTURE. PROVIDE NEW GRS CONDUIT AND JUNCTION BOXES ON SUPPORTS AS OUTLINED ON THE SPECIFICATIONS.
2	REUSE EXISTING HOMERUN BRANCH CIRCUITRY SAVED DURING DEMOLITION AND EXTEND CONDUCTORS AS REQUIRED TO RECONNECT EXHAUST FANS. PROVIDE CONDUCTORS AS REQUIRED TO EXISTING MOTOR RATED SNAP SWITCH AND EXISTING CONNECTION POINT.
3	REUSE EXISTING HOMERUN BRANCH CIRCUITRY SAVED DURING DEMOLITION AND EXTEND CONDUCTORS AS REQUIRED TO RECONNECT BARD UNITS. PROVIDE NEW GRS CONDUIT AND JUNCTION BOXES ON SUPPORTS AS REQUIRED FROM ROOF EDGE TO EXISTING BARD UNIT LFNC.
4	REUSE EXISTING HOMERUN BRANCH CIRCUITRY SAVED DURING DEMOLITION AND EXTEND CONDUCTORS AS REQUIRED TO RECONNECT MINI SPLIT. PROVIDE NEW GRS CONDUIT AND JUNCTION BOXES ON SUPPORTS AS REQUIRED FROM ROOF EDGE TO EXISTING CONNECTION.
5	EXTEND BRANCH CIRCUITRY SAVED DURING DEMOLITION TO MECHANICAL UNITS AS REQUIRED. PROVIDE NEW GRS AS REQUIRED TO SUPPORT NEW ROOFING WORK. SECURE CONDUIT AS OUTLINED IN THE SPECIFICATIONS.

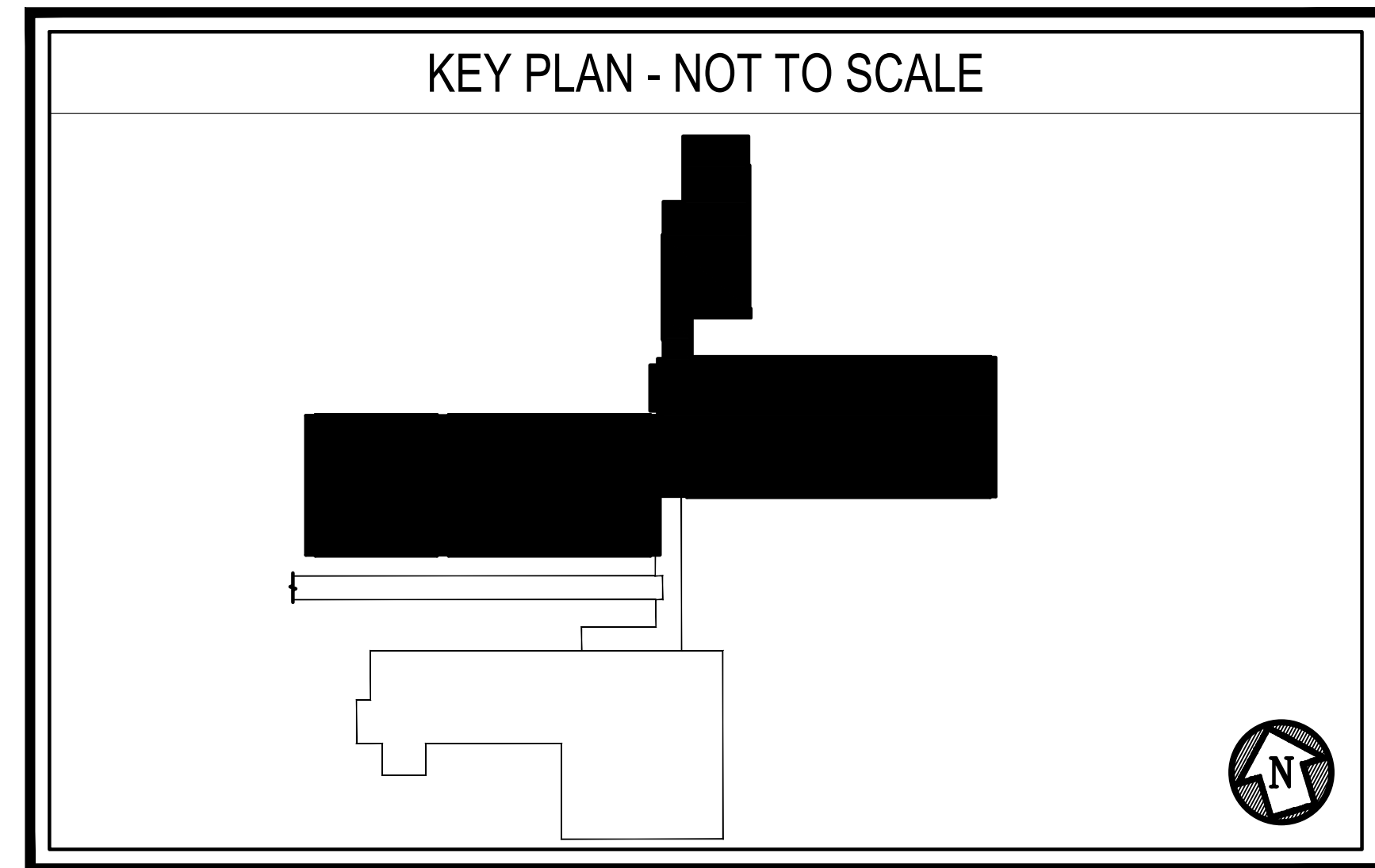

**OVERALL ROOF PLAN - NEW WORK**  
SCALE: 1/16" = 1'-0"

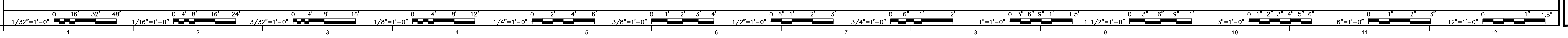

DESCRIPTION	
BY	RECORD DRAWINGS
MARK	DATE
REVISIONS	

**THOMPSON**  
CONSULTING ENGINEERS  
REGISTERED PROFESSIONAL ENGINEERS  
1000 UNIVERSITY DRIVE  
SUITE 1000, CHARLOTTE, NC 28203  
PHONE 704.366.1234

DATE	PROJECT	DESIGNED	DRAWN	CHECKED
05/15/2026	2103/08	LSC	LSC	KC

**RRMM**  
ARCHITECTS, P.C.  
1317 Executive Blvd, Suite 200  
Chesapeake, Virginia 23320  
(757)622-2828

**KENZIE CAMBAR**  
Lic. No. 049752  
05-15-2026  
PROFESSIONAL ENGINEER

**HISTORIC SOUTHSIDE HIGH SCHOOL EDUCATION CENTER  
DINWIDDIE COUNTY - DINWIDDIE EDUCATION ANNEX FACILITY**  
1238 BOYDTON PLANK ROAD  
DINWIDDIE, VIRGINIA 23041

PROJECT: OVERALL ROOF PLAN - DEMOLITION AND NEW WORK

DRAWING: E1.1

SHEET: E1.1



3 (//(&75.&\$/ 3+272  
( 127 72 6&\$/(



3 (//(&75.&\$/ 3+272  
( 127 72 6&\$/(



3 (//(&75.&\$/ 3+272  
( 127 72 6&\$/(



3 (//(&75.&\$/ 3+272  
( 127 72 6&\$/(



3 (//(&75.&\$/ 3+272  
( 127 72 6&\$/(



3 (//(&75.&\$/ 3+272  
( 127 72 6&\$/(

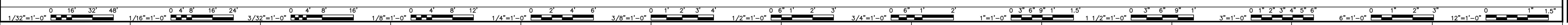

056, \$71  
5/9, 6, 216 5 (&25' 5\$; 1, 1'6  
'16&5.37.21

**THOMPSON**  
CONSULTING ENGINEERS  
1000 W. STATE ST. SUITE 100  
ANN ARBOR, MI 48106  
PH: 734.769.1000

\$71  
352-(87  
'(6, 11'  
'5\$; 1  
&+(8, (

**RRMM**  
ARCHITECTS, PC  
1111 HANCOCK BLVD. SUITE 200  
ANN ARBOR, MI 48106  
(734) 769-1000

STATE OF MICHIGAN  
KENZIE CAMBAR  
Lic. No. 049752

352-(87 +, 6725, & 6287+6, ( +, \* + 6&+22/ ('8&\$7,2  
'1, 1', ( &2817< '1, 1', ( ('8&\$7,21 \$11(; )\$8, /, 7  
'%2<721 3/(\$1, 52\$'  
'1, 1', ( 9, 5, 1, \$  
'5\$; 1, 1' (//(&75.&\$/ 3+2726

6+(7  
(